

PXA060 Exploded View

PXAX060 BILL OF MATERIALS			
Item	Part	Description	Qty
1	1125-TE-0016	Pump Body	1
2	2127-EP-0024	Head, Right	1
3	2127-EP-0025	Head, Left	1
4	14300-PF-0011	Bellows Assembly	2
5	5144-PF-0023	Shaft	1
6	5143-MP-0012	Seal, Shaft	2
7	14200-NP-0005	Plate, Base, Assembly	1
8	4140-TE-0002	Top Check Plug	2
9	4135-MP-0001	Seat, Check, Bottom, Hi-flow	2
10	4142-MP-0001	Cage, Check, Top, Hi-flow	2
11	4100-MP-0001	Ball, Check, 3/4"	4
12	10040-TE-0003	Plug, NPT, 1/4"	2
13	10040-TE-0006	Plug, 5/8", .300"	4
14	3200-VI-0001	Diaphragm, Ø.782	2
15	6150-UH-0001	Seat, QEV Exhaust	2
16	10080-VI-016-75	O-ring, 016 X .070	2
17	6150-NP-0007	Cap, Muffler, QEV	2
18	6140-FP-0002	Baffle Porous Poly QEV	4
19	6140-PP-0004	Mesh, QEV 04 & 05	6
20	10080-VI-019-75	O-ring, .019 X .070	2
21	8200-TE-0001	Adapter, Cap, Proximity	2
22	8110-NP-0005	Housing, Sensor	2
23	8600-XX-0057	Sensor, Proximity	2
24	10010-TE-0019	Nut, Jam	2
25	7200-PF-0006	Body, Flaretek®, 3/4"	2
26	7210-PF-0004	Nut, Flaretek®, 3/4"	2
27	6090-UH-0003	QEH Body, 05	2

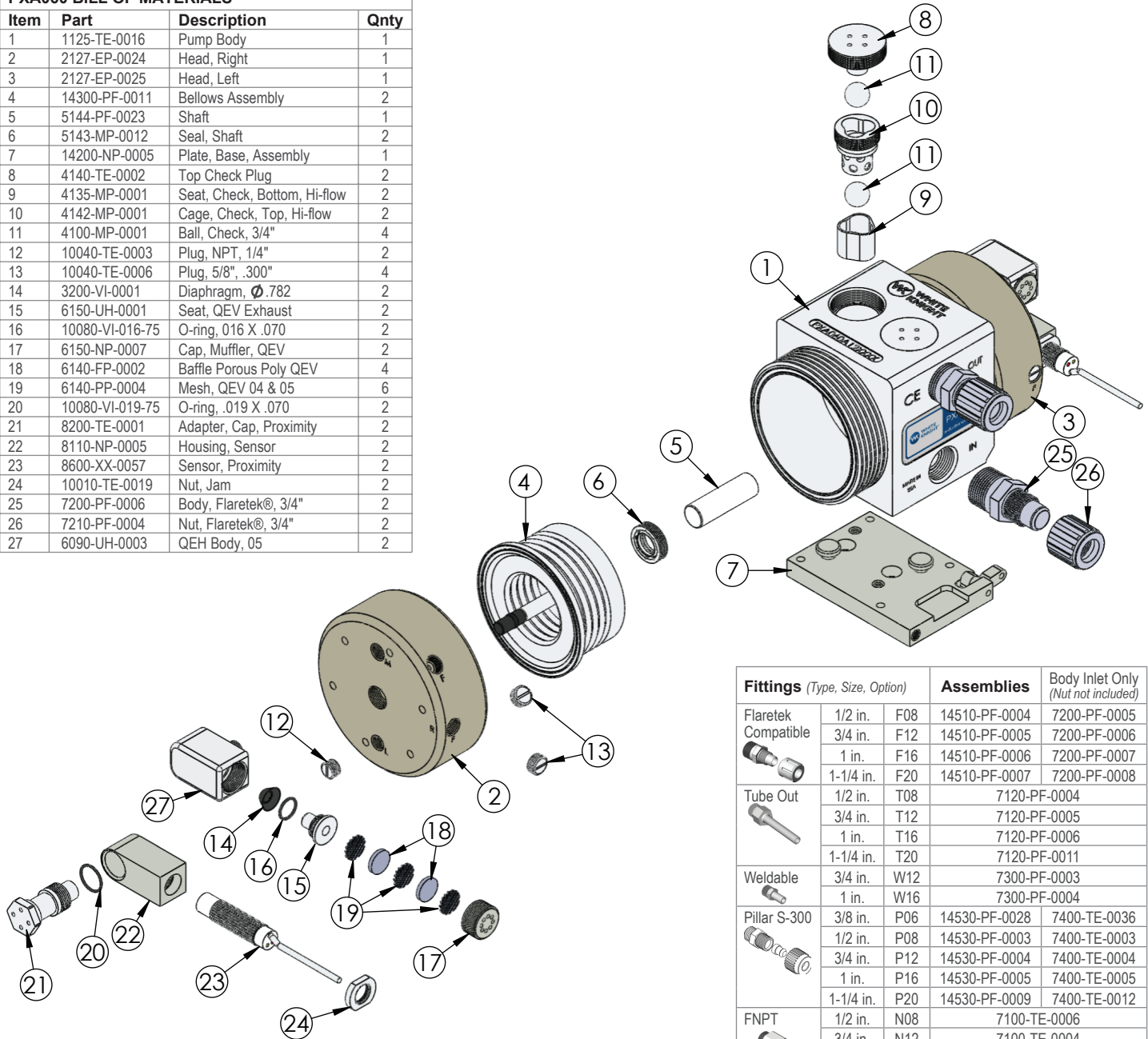

Leak Detect		
Part	Description	
14600-XX-0009	LF0	15 ft fiber optic cable with no amplifier
14600-XX-0010	LF1	15 ft fiber optic cable with D10 amplifier
14600-XX-0011	LF2	25 ft fiber optic cable with no amplifier
14600-XX-0012	LF3	25 ft fiber optic cable with D10 amplifier
14600-XX-0031	LC0	15 ft conductivity cable
14600-XX-0040	LC1	25 ft conductivity cable

Stroke Detect		
Part	Description	
14700-XX-0029	SX1	15 ft PNP normally open proximity switch

Fittings (Type, Size, Option)		Assemblies	Body Inlet Only (Nut not included)
Flaretek Compatible	1/2 in. F08	14510-PF-0004	7200-PF-0005
	3/4 in. F12	14510-PF-0005	7200-PF-0006
	1 in. F16	14510-PF-0006	7200-PF-0007
	1-1/4 in. F20	14510-PF-0007	7200-PF-0008
Tube Out	1/2 in. T08	7120-PF-0004	
	3/4 in. T12	7120-PF-0005	
	1 in. T16	7120-PF-0006	
	1-1/4 in. T20	7120-PF-0011	
Weldable	3/4 in. W12	7300-PF-0003	
	1 in. W16	7300-PF-0004	
Pillar S-300	3/8 in. P06	14530-PF-0028	7400-TE-0036
	1/2 in. P08	14530-PF-0003	7400-TE-0003
	3/4 in. P12	14530-PF-0004	7400-TE-0004
	1 in. P16	14530-PF-0005	7400-TE-0005
FNPT	1/2 in. N08	7100-TE-0006	
	3/4 in. N12	7100-TE-0004	
Synchro-Flare	1/2 in. S08	14520-TE-0003	7010-TE-0005
	3/4 in. S12	14520-TE-0004	7010-TE-0004
	1 in. S16	14520-TE-0006	7010-TE-0006
PrimeLock	1/2 in. L08	14570-PF-0003	7800-TE-0003
	3/4 in. L12	14570-PF-0004	7800-TE-0004
	1 in. L16	14570-PF-0005	7800-TE-0005
	1-1/4 in. L20	14570-PF-0012	7800-TE-0012
Plugged	B00	7130-TE-0003	

<https://wkfluidhandling.com/pxa-series/>